

## **SIGFRIDSON COUNTY PARK**

**Location:** Located on Hwy 202 at milepost 11, Olney Area  
**Size:** 64.43 Acres  
**Ownership Status:** County  
**Land-use zone:** Open Space Parks and Rec (OPR)  
**Classification:** Natural Area

### **Description/Natural Features:**

This county property provides stream bank access to fishermen along a stretch of the North Fork Klaskanine River downstream from the state fish hatchery.

This is a heavily used public fishing area during the winter steelhead season and also used by summer trout fishermen. This park is just downstream from an active fish hatchery and is known locally for fantastic fishing. The site receives light usage as a day-use picnic area during the summer months.

### **Facility Inventory:**

- Informal parking area
- Primitive trails



### **History:**

In 1969, the community based "Save Klaskanine" group began seeking financial donations to purchase an option on 72 acres of land known as the Sigfridson Farm. The "Save Klaskanine" group recognized the rare opportunity to purchase nearly 3,000 linear feet of river frontage to maintain public access and high quality fishing opportunities for county residents and visitors. By the middle of 1969, the group had raised nearly \$300 of the \$700 cost for the option, and the county and the Game Commission were solicited for financial assistance. By the end of the year, Clatsop County purchased the property for park purposes.

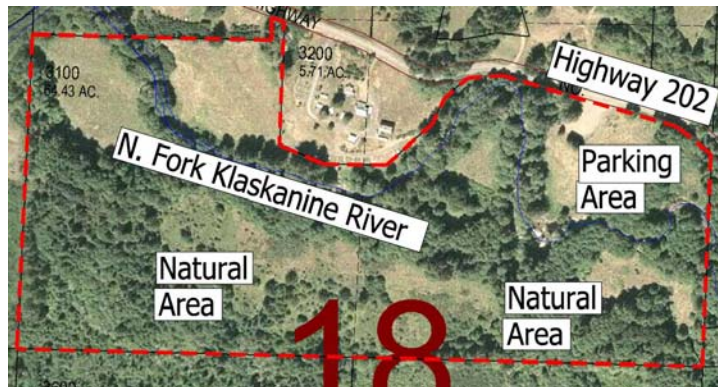

In the mid-1980s, the county leased 5.7 acres of the park, including the residence and farm buildings. A subsequent land sale of the leased parcel reduced the park from its original 72 acres to its current 64 acres

### **Acquisition by County:**

According to county record, in December 1969, the county purchased the acreage for parkland for \$45,000.